



Norwegian Pearl

Experience the wonders of Freestyle Cruising®, as well as getting to work, aboard Norwegian Pearl. Her chic bowling alley, rock climbing wall, 17 delicious dining options, 13 bars and lounges, casino, spa, pools, fitness center, 3-bedroom Garden Villas and so much more make this Jewel Class ship a destination of her own.



Barcelona Meeting Room



Stardust Theater

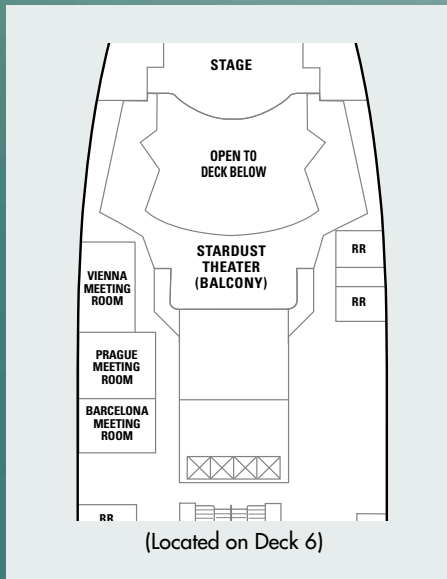

Suites and Staterooms

- 3-Bedroom Garden Villa (Qty: 2)
- Deluxe Owner's Suite with Large Balcony (Qty: 2)
- Owner's Suite with Large Balcony (Qty: 4)
- 2-Bedroom Family Villa with Balcony (Qty: 8)
- Courtyard Penthouse with Balcony (Qty: 2)
- 2-Bedroom Family Suite with Balcony (Qty: 10)
- Penthouse (Qty: 20)
- Mini-Suite (Qty: 134)
- Balcony (Qty: 360)
- Oceanview (Qty: 189)
- Obstructed Oceanview (Qty: 54)
- Inside (Qty: 412)

Meeting Rooms

- Vienna Meeting Room**
Deck 6
Seating Capacity B: 20
(366 sq. ft.) (34 m²)
 - Prague Meeting Room**
Deck 6
Seating Capacity B: 20, C: 24, T: 30
(441 sq. ft.) (41 m²)
 - Barcelona Meeting Room**
Deck 6
Seating Capacity B: 20, C: 24, T: 30
(398 sq. ft.) (37 m²)
 - Stardust Theater**
Decks 5, 6, 7
Seating Capacity 1,042
(12,917 sq. ft.) (1,200 m²)
- Prague and Barcelona Rooms can be combined for C: 48

B – Boardroom Style
C – Classroom Style
T – Theater Style

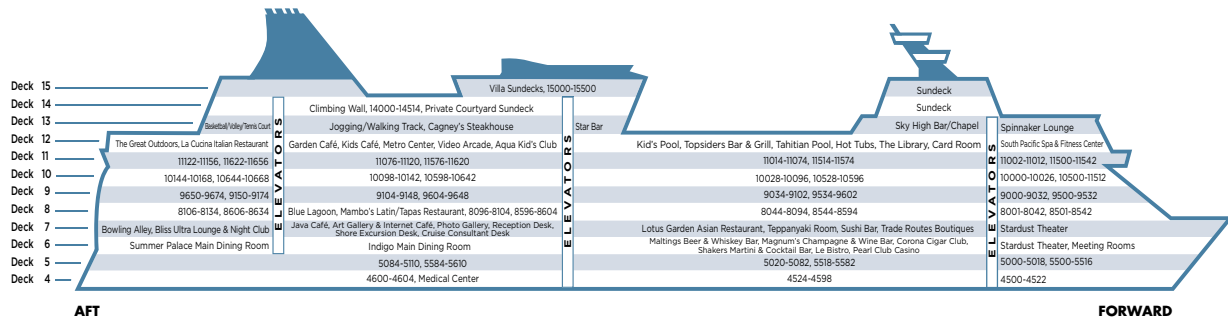

Dining Options

Summer Palace Main Dining Room

Morning, noon and night, this very elegant dining room offers an ever-changing menu of everything from five-course feasts to healthy, light entrées. Seating Capacity 558 (12,195 sq. ft.) (1,133 m²)

Indigo Main Dining Room

The ultra-modern design complements the lighter menu in this contemporary restaurant with great views. Seating Capacity 304 (5,705 sq. ft.) (530 m²)

Le Bistro French Restaurant

Our signature gourmet French restaurant with nouvelle and classic dishes. Seating Capacity 102 (2,594 sq. ft.) (241 m²)

Lotus Garden Asian Restaurant

This dining complex offers four unique Asian restaurants:

- **Thai/Chinese/Japanese** restaurant with an Asian fusion menu.
- **Sushi Bar** with fresh fish creations including Nigiri, Maki, Temaki and special rolls.
- **Shabu Shabu** Take part in a Japanese tradition, where delicately sliced meat and vegetables are cooked by you in "dashi" or a hot broth.
- **Teppanyaki Room** with freshly prepared, authentic Teppanyaki. Seating Capacity 146 (2,368 sq. ft.) (220 m²)

Cagney's Steakhouse

Who's in the mood for a real American steakhouse? Succulent steaks, filet mignon, prime rib, lamb, fresh seafood and grilled chicken. Seating Capacity 168 (4,026 sq. ft.) (374 m²)

Mambos Latin/Tapas Restaurant

It's a zesty experience with modern Mexican, Tex-Mex tapas bar and Spanish recipes. Seating Capacity 94 (2,766 sq. ft.) (257 m²)

Garden Café/Kid's Café

If you like your food fresh à la minute, you'll love this indoor buffet-style restaurant. On-the-spot preparation of omelettes, waffles, and pasta, plus fresh fruit, soups and salads. Seating Capacity 378 (12,368 sq. ft.) (1,149 m²)

The Great Outdoors

This spacious outdoor buffet serves all your favorites made to order. Seating capacity 258 (6,717 sq. ft.) (624 m²)

Topsiders Bar & Grill

Grab a bite to eat on the pool deck with grilled burgers, chicken and refreshing drinks. Seating Capacity 275

Java Café

Satisfy your sweet tooth cravings or enjoy a light snack with muffins, cupcakes, scones, cookies and more. Seating capacity 75 (1,399 sq. ft.) (130 m²)

La Cucina Italian Restaurant

It's like dining with ocean views along the Italian Riviera where you can select from delicious pastas, pizzas and other authentic Italian dishes. Seating Capacity 102 (2,433 sq. ft.) (226 m²)

Blue Lagoon

A 24-hour eatery for everything from hamburgers to fast-wok dishes. Seating Capacity 98 (2,056 sq. ft.) (191 m²)

Sky High Bar & Grill

Colorful, hot-air balloon-themed grill. Seating Capacity 91 (1,507 sq. ft.) (140 m²)

Room Service

Available 24 hours.

Bars & Lounges

Sake Bar

Tucked inside our Asian restaurant, this full bar also offers premium sake and imported beer. Seating Capacity 6

Mambos Latin/Tapas Restaurant Bar

In the mood for something refreshing from south of the border while you're in our tapas bar? How about a Margarita? Sangria? Dos Equis? We've got them all and then some. Seating Capacity 10

Spinnaker Lounge

Panoramic views make this the place for parties and informal meetings. Seating Capacity 340 (9,042 sq. ft.) (840 m²)

Pearl Club Casino Bar

Toast your winning streak at this exciting bar. Seating Capacity 326 (8,342 sq. ft.) (775 m²)

Bliss Ultra Lounge & Night Club

Night and day, this hip, high-energy complex has bowling, plasma screens for sports and music videos and more. Seating Capacity 59 (3,907 sq. ft.) (363 m²)

Maltings Beer & Whiskey Bar

A traditional English pub with English Pool and large-screen TVs. Seating Capacity 42 (872 sq. ft.) (81 m²)

Star Bar

A popular hot spot on the ship for casual get-togethers. Seating Capacity 42 (1,216 sq. ft.) (113 m²)

Magnum's Champagne & Wine Bar

Sip your favorite champagne and wine in this upscale Art Deco lounge. Seating Capacity 44 (1,615 sq. ft.) (150 m²)

Java Café

For that frozen, double-whipped coffee treat, the Java Café is at your service with a wide variety of specialty coffees, tea's, pastries and cookies. Seating Capacity 75 (1,399 sq. ft.) (130 m²)

Shakers Martini & Cocktail Bar

Happy hour never ends at this popular spot to meet new friends and have a cool cosmopolitan. Seating Capacity 33 (807 sq. ft.) (75 m²)

Sky High Bar

Colorful and casual beach bar offering snacks and cocktails. Seating Capacity 91 (1,507 sq. ft.) (140 m²)

Topsiders Bar

Poolside bar serving cocktails and soft drinks. Seating Capacity 275

The Great Outdoors Bar

Fresh air, fantastic views and your favorite drinks at this cool bar. Seating Capacity 12

To learn more about Norwegian Pearl,
visit events.ncl.com or call
1.866.NCL.MEET (625.6338)